

ROCKFORD

SQUARE FOOTAGE

2,106	Total Finished
1,294	Second Level
812	Main Level
812	Optional Basement

HOME SPECS

4	Bedrooms
2.5	Baths
2	Car Garage
36'0	Width
42'0	Depth

PRICING

Elevation A-

Elevation B-



ELEVATION A



ELEVATION B

ROCKFORD

MAIN LEVEL

812 sq. ft.

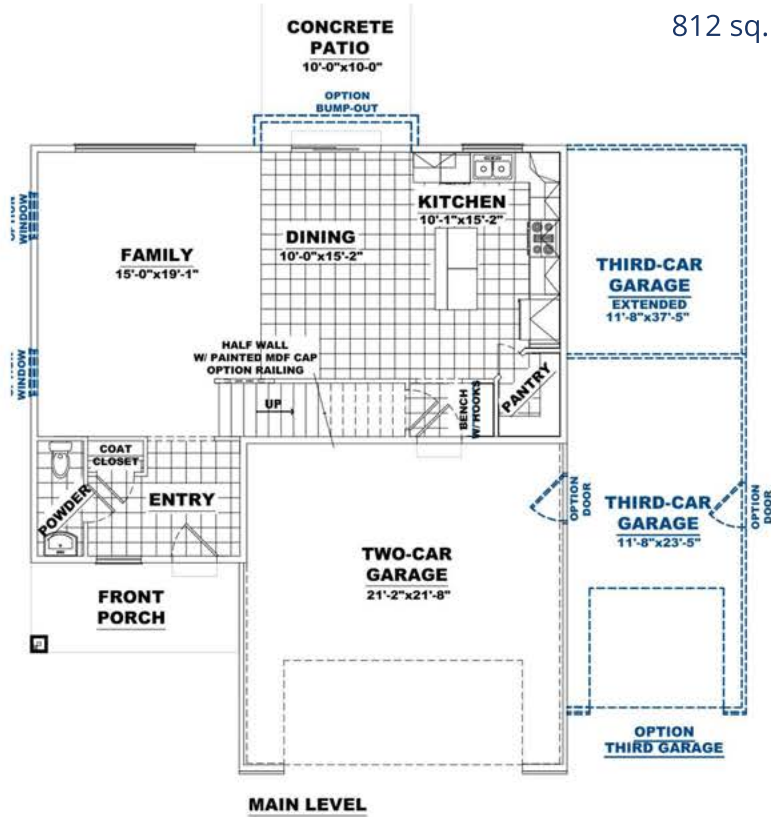

SECOND LEVEL

1,294 sq. ft.

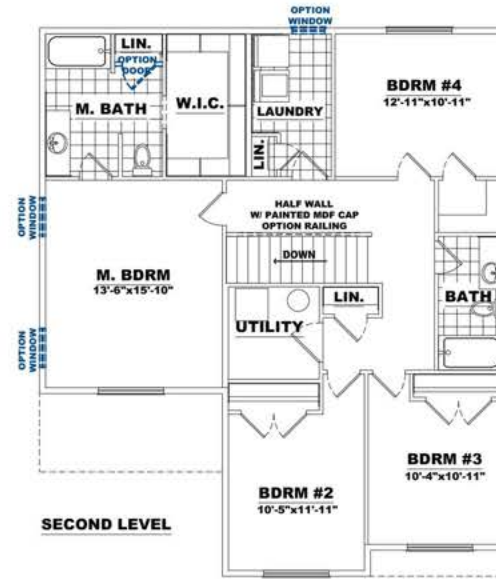

OPTIONAL BASEMENT

812 sq. ft.

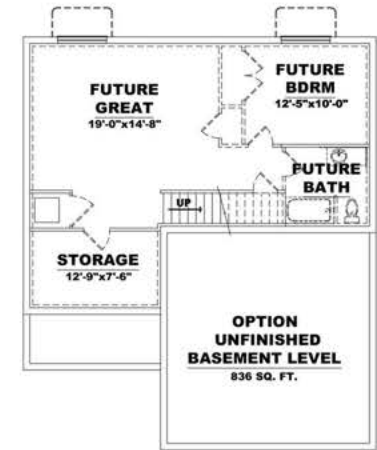

OPTION M. BATH



OPTION LAUNDRY

