

# AUSTIN

## SQUARE FOOTAGE

<b>3,386</b>	Total Footage
<b>1,693</b>	Main Level
<b>1,693</b>	Basement

## HOME SPECS

<b>3-6</b>	Bedrooms
<b>2-3</b>	Baths
<b>2-3</b>	Car Garage
<b>52'0</b>	Width
<b>48'2</b>	Depth

## PRICING

Elevation A-

Elevation B-

Elevation C-



ELEVATION A



ELEVATION B



ELEVATION C

# AUSTIN

## MAIN LEVEL

1,693 sq. ft.

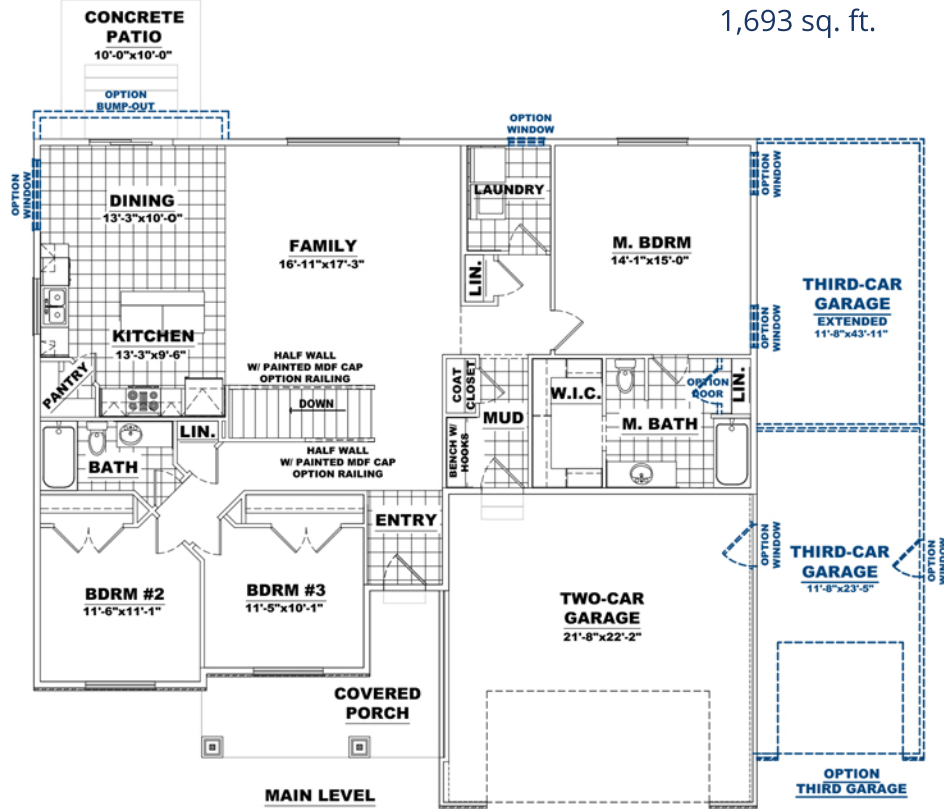

## UNFINISHED BASEMENT

1,693 sq. ft.

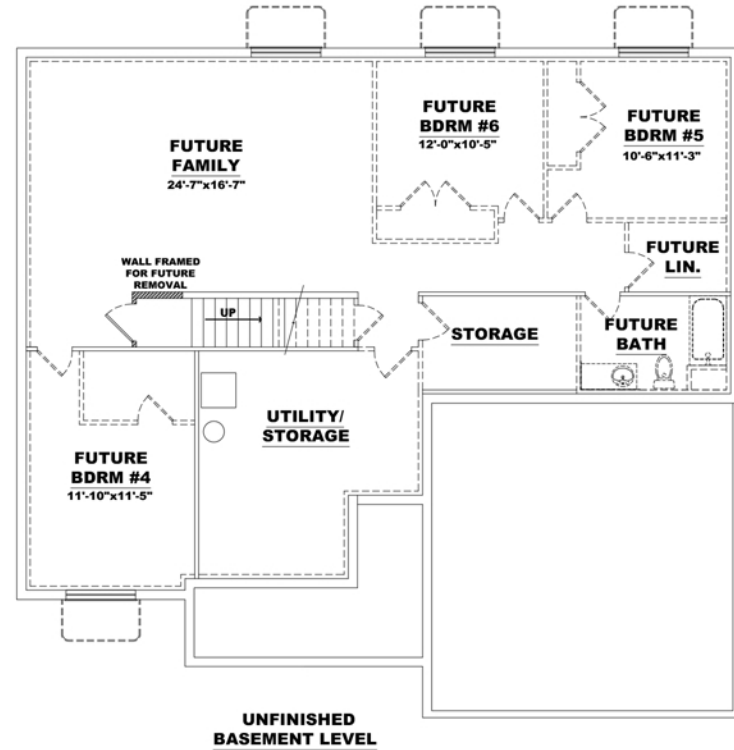

### OPTION M. BATH

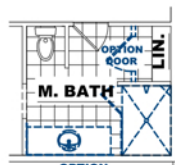

OPTION V72 - (1) SINK  
V72 - (2) SINKS  
OPTION "A"  
60"x42" SHOWER  
W/ LINEN CLOSET

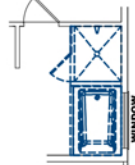

OPTION "B"  
60"x42" SOAKER TUB  
W/ 42"x48" SHOWER

### OPTION LAUNDRY



OPTION "A"  
SHELF  
OPTION "B"  
UPPER CABINETS W/ ROD  
OPTION "C"  
UPPER CABINETS W/ ROD  
& LOWER CABINET, OPTION SINK