

PRINCETON

Slab-on-Grade

SQUARE FOOTAGE

1,897	Total
1,113	Second Level
784	Main Level

HOME SPECS

4	Bedrooms (w/Loft)
2.5	Baths
2-3	Car Garage
36'	Width
38'	Depth

PRICING

Farmhouse-

Craftsman-



Farmhouse



Craftsman

PRINCETON

Slab-on-Grade

MAIN LEVEL

784 sq. ft.

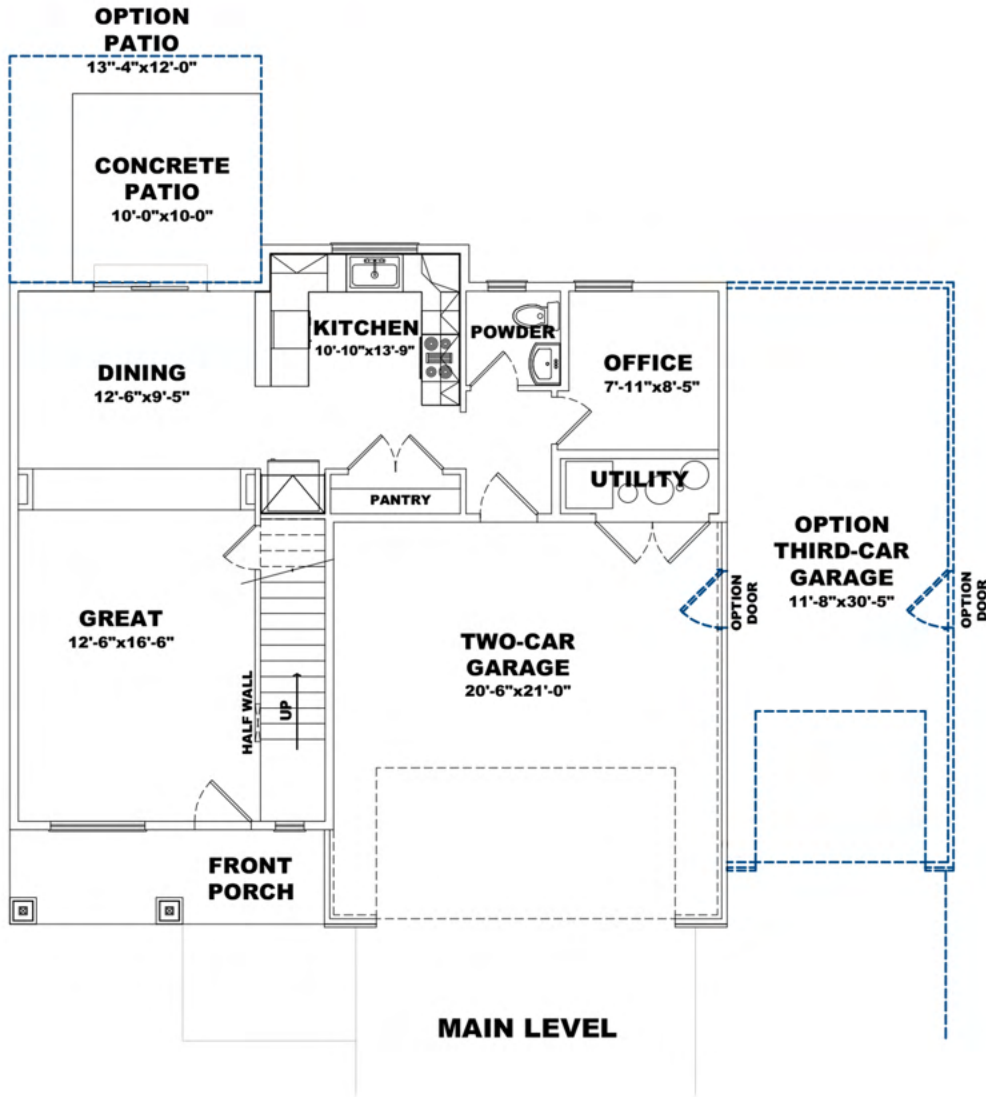

SECOND LEVEL

1,113 sq. ft.

